

QUICKGRIP SYSTEM - FITTING INSTRUCTIONS

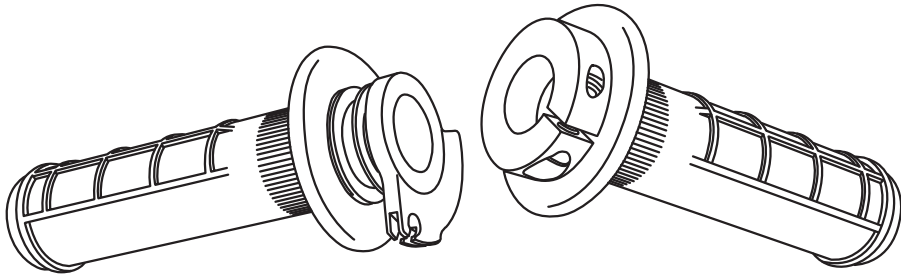

FACTORY ONE RACING

QUICKGRIP SYSTEM - INITIAL FITTING

Follow the instructions below when fitting the QuickGrip system to your bike for the first time:

- 1) Place the end plugs into the ends of the grips and knock them in firmly using a rubber mallet or similar.
- 2) Remove the throttle assembly from the handlebar, disassemble and re-assemble with the alloy rotor in the same way as you would a standard throttle tube.
- 3) Once the throttle is back together attach the grip to the rotor by holding back the rubber flange of the grip and slotting them together at right-angles to the handlebar (see diagram overleaf).
- 4) Slide the whole assembly onto the handlebar, remembering to clean then lubricate the bar, tighten the throttle assembly in accordance with manufacturers instructions.
- 5) Assemble the other grip and the clutch-side clamp as per throttle side, then slide them onto the handlebar (see diagram overleaf). Please note that some knurled handlebars may require minimum dressing in order to restore bar's tolerance.
- 6) Tighten the clamp as tight as possible using the hand tool supplied - do not use a larger tool as this may lead to over-tightening and damage.



CAUTION: Read these instructions carefully before installing or using QuickGrips

IMPORTANT INFORMATION:

QuickGrip system should be maintained as part of the motorcycle. This includes cleaning and regular checks in order to maintain good condition of the product. It is the riders responsibility to check his/her machine before riding, this includes the QuickGrip system. Factory One Racing cannot be held responsible for any failure of the product, missuse or misfitting.

SWITCHING QUICKGRIPS

QuickGrips are designed to be switched in under 30 seconds. Simply follow the instructions below:

- 1) Loosen throttle screws and clutch side clamp screw.
- 2) Slide each to the end of the bar as far as is necessary for the grips themselves to become disengaged from the bar, thus allowing detachment from the rotor or clamp. It is not necessary to totally remove these parts from the bars (unless you want to).
- 3) Detach the old grips and attach the new ones by holding back the rubber flanges of the grips and slotting them together at right-angles to the handlebar (see diagram overleaf).
- 4) Slide both sides back into position, remembering to clean and lubricate the throttle side bar.
- 5) Tighten the throttle assembly in accordance with manufacturers instructions., and tighten the clutch-side clamp as tight as possible using the hand tool supplied - do not use a larger tool as this may lead to over-tightening and damage.

ASSEMBLY DIAGRAM - CLUTCH SIDE

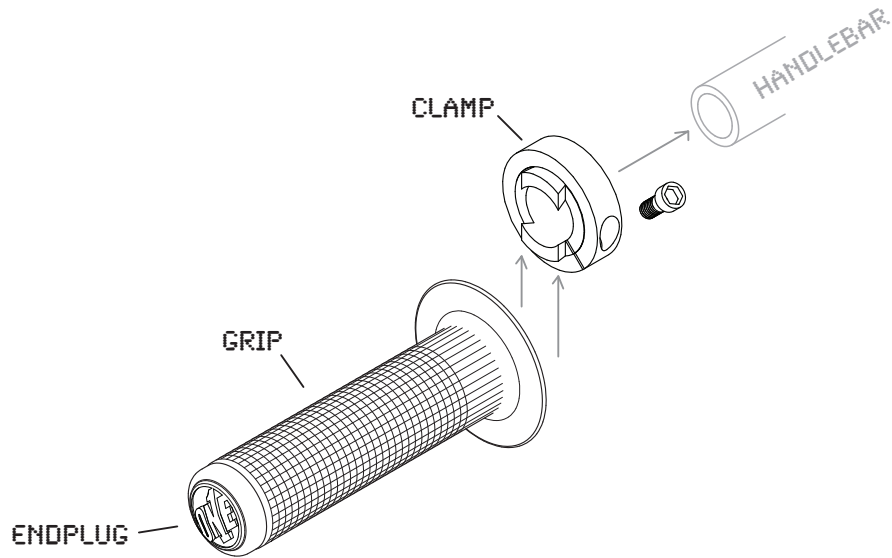

USING THUMB SAVERS

Thumb Savers sit against the inner flange of your regular grips, and with just a small amount of lubrication between them and the grip they rotate freely. This means they stay with your thumb when it moves, and prevent rubbing between your thumb and the grip. To fit them simply follow the instructions below:

- 1) Fit the thumb savers to both grips by pulling them on until they fit flush with the inside of the grips.
- 2) Lubricate each thumb savers by putting a small amount of lubricant between it and the grips. The ideal lubricant for this is a water based detergent such as washing-up liquid. Do not use much as only a small amount is required, and you do not want it to spread out onto the grips themselves - just use enough so that the thumb savers can rotate freely on the grips.

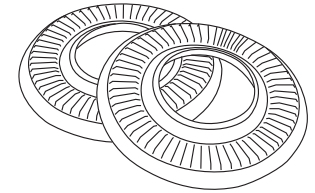

ASSEMBLY DIAGRAM - THROTTLE SIDE

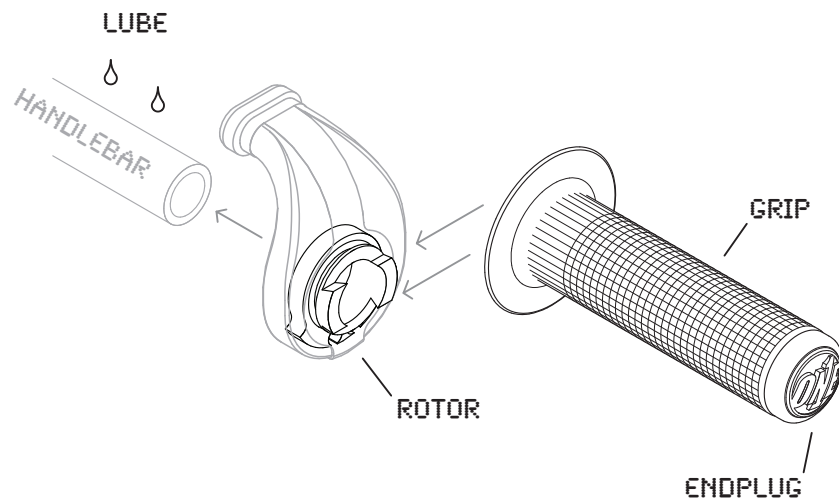

USING MUD STRIPPERS

Mud Strippers clear mud from grips in seconds.

Fit the mud strippers to your extreme grips by pulling them on until they fit flush with the inside of the grips. Once fitted, ride as normal.

To remove excess mud, grab the mud stripper by both tabs and quickly pull it off the grip, taking any mud off with it as it comes.

Mud strippers are designed to be disposable, however there is nothing to stop you cleaning them off and using them again while they are still in one piece.

